

# Public Document Pack

## **Supplementary information for Scrutiny Board (Children's Services) on 23 July 2015**

Item 7 – Public Request for Scrutiny

This page is intentionally left blank

Supplementary information Scrutiny Board (Children's Services) 23 July 2015  
Item 7, Public Request for Scrutiny

- 1) Email correspondence of Tom Riordan – Chief Executive Leeds City Council to Friends of Gledhow Field 20<sup>th</sup> July 2015
- 2) School Response to the document produced by Friends of Gledhow Field (15<sup>th</sup> July version),
- 3) Results and Findings of a Survey, Petition, Research and Community Engagement Campaign by the Friends of Gledhow Field (15<sup>th</sup> July Version)
- 4) Briefing note 24 June 2015, with appendices
- 5) Consultation Summary
- 6) Report to Executive Board Outcomes of statutory notices to increase primary school provision in Roundhay 17 December 2014.

This page is intentionally left blank

**E – mail correspondence of the Chief Executive Leeds City Council to the Friends of Gledhow Field**

**From:** Riordan, Tom  
**Sent:** 20 July 2015 10:18  
**To:** [info@friendsofgledhowfield.org](mailto:info@friendsofgledhowfield.org)  
**Subject:** The Future of Gledhow Field

Dear Mr Sellars

Thanks for your email. Having discussed the issues with the appropriate Council officers, I can now offer the following response, which is further to those that I believe have already been provided to you at your meetings of 18<sup>th</sup> June and more recently 13<sup>th</sup> July 2015 with local ward Members.

As you may be aware, there is a significant shortfall of primary school places in the Roundhay area, a situation which the Council is proactively trying to redress. The expansion of Gledhow Primary School to a 3FE primary school is a key element in seeking to ensure that no child is left without a placement at one of their local schools.

The impact of expanding Gledhow Primary School extends to both the physical building and associated grounds. The proposed development will result in a large displacement of hard play and an element of sports pitch provision due to the construction of a new teaching block. Whilst every endeavour has been made to minimise the impact upon existing external facilities it is not possible to expand the current school buildings to accommodate a 50% increase in pupil numbers, from a 2FE to a 3FE school, without the loss of some of these areas. By increasing the number of pupil places at the school, there is a need to both re-provide outdoor space lost as a consequence of expanding the school building, and to increase the overall outdoor space provision in a safe and secure setting to safeguard the health and wellbeing of pupils. To this end the school, supported by the Council, believes it is necessary to 'fence in' all of their the outdoor space, to ensure pupil safety and enable it to be secured overnight to guard against the possibility of dog excrement, fly tipping, needles and any other activities which may create a pupil safeguarding issue.

It is my understanding that the school and its Board of Governors has committed to maintaining community access to the area of 'the postage stamp' proposed to be fenced in, by way of community lettings from which they will not seek to profit.

You raise in your correspondence the issue of funding the proposed fencing. The cost of the fencing will be covered from the bulge cohort programme of works to enable an earlier (September 2015) additional form entry (30 pupil) intake at Reception class and not S106 monies.

I acknowledge your assertion that the Friends of Gledhow Field does not hold a view point on the expansion of the school, and that your sole concern is the fencing in of 'the postage stamp' field to the rear of the school. It is hard to separate one issue from the other given that with the need to expand the school comes the intrinsic need to increase the outdoor space provision in a safe and secure manner.

Whilst I can appreciate the local communities concerns over loss of freely accessible greenspace, the proposed enclosure of 'the postage stamp' does leave a peripheral area around two sides of the fence line which the public can access. Furthermore, the community does have within close, or reasonable proximity a number of other greenspaces: there is a well-established park at the corner of Chandos Gardens and Lidgett Lane, immediately to the north of the school, which includes a children's play area and informal open greenspace; Gledhow Valley Woods and Chapel Allerton Park are both within half a mile; and additional areas of accessible greenspace in the locality exist at Lincombe Mount and Allerton Grange Fields.

On the matter of there being time for further community engagement and consultation, as I am sure you will understand both the school and Council (as the Local Education Authority) before entering into an agreement to expand need certainty that an increased outdoor space requirement can be delivered. Leaving this critical element of a school expansion unconfirmed would call into jeopardy the viability of the whole scheme.

Regarding the Roundhay Neighbourhood Design Statement, which has been adopted as a supplementary planning document, from a planning point of view it would only have relevance if there was a planning application, which due to the height of the proposed fence (less than 2m) is not required. The design statement does include a range of community aspirations and recommendations, of which safeguarding of the field appears to be one, as well as access to 'the postage stamp' needing clearer definition. Both of which points aim to be addressed by formalising use of the field and access points to it.

The history to the field, as I am sure you are aware, is that the area was acquired by the Council in 1945 for the specific purpose of education provision, not for the benefit of the citizens of Leeds (as much land acquired by the Council overtime has been) and with no restrictions on the title as to the site's use. The land has been accessible for public use but is not formally designated Public Open Space. Whilst the school did not fence in 'the postage stamp' along with the rest of its outdoor space following the 1996 Dunblane tragedy, the area has continually been maintained by the school, at its expense, or through lease arrangements it entered into in respect of the field (Leeds Rugby Club 1983 to 2006).

As a point of clarification I would like to make it clear that neither the Council nor school has any intention to utilise the field for anything other than team sports for the school and local community. I understand that the petition which gathered 400 signatures was based on 'the postage stamp' being developed as a private 'Soccer Centre', which is not the case.

To conclude, as you will appreciate, the demand for school places within the Roundhay area is reaching critical mass. The permanent expansion of Gledhow Primary School, from a 420 place primary to 630, is an essential component of the strategy to address pupil place need within the ward. As a valued community body Gledhow Primary School has pushed the Council to ensure the 'outstanding' standards and ethos of the school are not diminished as a consequence of the expansion. Of key concern for the Board of Governors is the need to ensure every pupil has access to a first rate physical education curriculum, and this can only be achieved with the addition of 'the postage stamp' to the formal boundary, which the school has continually maintained.

Further to the above I believe your concerns are now to be considered at Scrutiny Board on 23<sup>rd</sup> July 2015 and therefore an opportunity will exist for discussion of much of the above.

Kind regards

Tom

Tom Riordan  
Chief Executive  
Leeds City Council

## Response to the document produced by Friends of Gledhow Field (15<sup>th</sup> July version), available on their website (<http://friendsofgledhowfield.org/>)

The preamble to the report link says *The Friends of Gledhow Field have compiled a report which gives the results of our survey, petition, research and community engagement campaign. We believe this report is a fair, honest and accurate statement of the facts.*

We regret to say that the School does not share the view of the last sentence, as outlined below. Quotes from the report are indicated in italics. The response broadly follows the order of the report, but one of the closing statements is dealt with first for clarification:

***This report was prepared by the Friends of Gledhow Field for presentation at a meeting on Monday 13<sup>th</sup> July 2015 to the school, Local Councillors and LCC staff.***

This is not the case. While some parts of it were read out by the FGF representative, it was not presented at the meeting, so there was no opportunity for scrutiny and comment until now. It was emailed to us on the 15<sup>th</sup> July, and some of our concerns are noted below.

### **Background**

- *The field behind Gledhow Primary School, (known locally as the 'Postage Stamp' or 'Gledhow Field'), will be fenced off this summer, (August 2015).*

There continues to be reference to 'the field' in this report and the website as though it were separate from the school. As has been pointed out repeatedly by the School and Council, the land is legally the school playing field. This kind of language throughout serves to reinforce the false impression that the school is grabbing public land.

- *The reason given is that there are plans for the school to grow from 2 to 3 Form Entry, (they will have an extra 7 classes, 1 per school year, which amounts to an additional 210 children), and, if that happens, the school would like more land for their expansion. This is subject to planning permission being granted.*

The school would not like more land for its expansion. It wants to securely fence its existing land for the safety of the children, to meet minimum planning guidelines for sports field areas, and to ensure continuing outstanding curriculum provision.

- *There are no legally binding restrictions on how much land a school must have therefore the school's expansion programme could go ahead without the additional land.*

No it could not. The Governing Body, informed by planning guidance, is clear that expansion requires the full use of its land. It is not the place of FGF to dictate how the school operates.

### **The Friends of Gledhow Field (FoGF)**

- *As a result of the planned closure of the field ...*

Or alternatively, "As a result of the school needing to re-fence its land"...

### **Statistical Results**

#### **Petition**

- *More than 450 people have signed the 'Save Our Field' petition to date.*

We think that respondents were misled throughout, and more responsible and accurate information may have produced somewhat different results. This is the text above the petition:

*The field behind Gledhow Primary School in North Leeds is the last open space accessible by the public in the locality. It has been freely used by the local community for over 20 years. Now the school is planning to build a fence to enclose most of the field and has expressed an interest in forming a partnership with a private company to build changing rooms and all weather playing surfaces on the field. These surfaces would also be used in the evenings. If we lose this field there is nowhere left for local children to play or anyone else to enjoy the peace and quiet. The park is too far away and the woods are not safe for young children. Please help us to preserve this hidden gem for public enjoyment for present and future generations to come.*

This has remained even though the inaccuracies were pointed out to FGF at a meeting on 18<sup>th</sup> June. On 14<sup>th</sup> July (26 days later), a supplementary 'update' was added below which could only be fully read by clicking on a link. This said:

*14 Jul 2015 — But please don't stop sharing - let's get it over the 500 mark.*

*Update - We are pleased to report that the organisation with whom Gledhow Primary School entered into a dialogue with regarding all weather pitches has withdrawn its interest and we are advised that the school/council now has no current plans under consideration to pursue this option. Phew!!!! However, this does not affect the plans to close the field to public access so we still need your signatures to keep the land open and free for the community.*

*Please note that we have a paper petition running alongside the online one so have a bigger total than shown here. Make sure you don't sign both!*

*Thank you for your support.*

This belated change still implies there was ever a plan to have all weather pitches. There was not.

#### **Appendix 1 Summary Of Comments From Petition**

This is not a summary of comments, it is a selection of those which support the view of FGF. It is equally possible to select those comments which show respondents have completely misunderstood the ownership and plans for the school playing field. Of the 125 comments visible on 14<sup>th</sup> July, the following 30 (just under 25%) illustrate this:

Gledhow already have a HUGE playing field they could build on, with plenty of space left over! Excess traffic in the area (due to children not from the local area) will be horrendous as it is shocking enough now!
Don't go fencing it off and sticking artificial surfaces on it!
An all weather sports pitch would prevent rainwater being able to soak into the ground efficiently and would be damaging to wildlife such as bees
We need to keep as many of our green fields as possible, and it would appear that Gledhow PS is probably looking at financial gain. I agree with all that is said in the statement to Leeds CC and Gledhow PS
It constitutes a public right of way, and is also the last green space in the whole area. It must not be built on.
We don't need more houses built by greedy developers. We need a better system for maintaining and filling the houses that are standing empty and neglected.
There appears to be a greedy business plan to exploit this space and a disregard for the local environment.
The school can still use it for Sports Day enclosing it with a fence restricts who can use it and when.
There are many empty houses use these to house people not precious green space
I'm signing because - as an ex-pupil of Gledhow CP School I recognise that the open space is a community asset, and should not be lost as a private/income generating one.
I do not feel schools should be focusing on this sort of enterprise. Their role is to manage their school. The government should provide enough funding to enable the school to be run effectively without having to resort to using common land to raise money. This land was provided for all the community - there is a major risk that this will no longer be the case. The school currently has adequate outside space for its primary pupils.
On balance of potential usages, while there would be some community gain from the proposed all-weather pitches, keeping the field open for the widest possible access by the community seems preferable,
This doesn't belong to the school, it is for the people who live in Gledhow/Brackenwood, they've got enough space as it is, have you seen the size of the playing fields they have!
Stop the degradation and sell-offs!
the school are wrongly claiming this land
I think the school has a adequate size playing fields.



I think this would also take away natural habitats and destroy the environment. It would also create noise pollution and the increase of people around this area would make the environment suffer as there wouldn't be enough room for parking and it would increase the amount of litter.
A company now wants to change this field allegedly into a paying football field which will stop a lot of these children being able to use it as many will not be able to afford to pay. I fear down the line houses will then be built on this space.
Green space is so important in a city, more important than making a sale for a quick buck. Also, it belongs to the public, it's not the councils to sell.
We are losing green fields by the day and before many years have passed the entire country will be one mass of concrete. It must stop!
The school do not need what they are saying
There's way too much been built on our precious land due migrant over flow.
There are many green spaces in North Leeds under threat of disappearing under bricks and concrete!
I do not agree with building on school playing fields
There is absolutely no need for this
Our birds, hedgehogs etc are already in decline because of loss of habitat. Green space also needed for rainwater to be absorbed.
would be a huge shame to see it gone to another 'goals' football pitch. There are plenty of other locations to develop in roundhay and throughout leeds, places that need it more than we do.
To lose it to what on the surface appears to be a commercial enterprise would be totally wrong & would not serve the interests of the local population.
Stop privatizing our common land!
It's bad enough that the government in the past have sold off school fields, lets not now reverse that by permitting the acquisition of public land for private school use.

13 of the 125 respondents who left comments (just over 10%) are not from Leeds – some as far as London and Edinburgh, so it is not an entirely local survey. The rest say Leeds, although it is not clear if they are actually from the local community.

### **Survey**

*(Please note: Respondents were also asked about their views on all-weather pitches as, at the time, it had not been made known that the private organisation had withdrawn their interest. For future reference, should all-weather pitches be something that is explored at a later date, the results relating to this were as follows:*

- *When asked whether they would like to see all weather pitches on Gledhow Field, 91% of people said 'No'*
- *When asked whether they would be prepared to pay to use sports facilities on Gledhow Field, 93% of people said 'No'*

As with the petition, the nature of the background information presented to people meant they had an entirely false view of the plans for the land. At no point did FGF contact the school to ask if there were any plans. Instead of a simple letter or phone call, or request for a meeting for clarification or to voice any concerns, FGF set up a formal Group, developed a website populated with inaccuracies and conjecture, and designed what we believe was a misleading petition and survey. Despite repeated attempts to convince FGF that there are no such plans and never have been, they persist in maintaining this impression.

### **What's the Answer?**

#### **Short Term – A Temporary Stop on Erecting the Fence for Twelve Months**

*The school will only have one extra class next year and, even though it has lost some of its land to the 'Reception Village', it will still have more than adequate space to fulfil the requirements of the school's Physical Education curriculum. (See appendix 2 which details the space within the school timetable for additional PE lessons).*

No it will not. It is losing sports field and playground space while accommodating more children and staff. Again, it is not for FGF to decide what is 'adequate' space.

## **Appendix 2 School Timetable**

We find it entirely inappropriate that FGF have taken this from the school website and see fit to dictate how and when the school should deliver its curriculum and design the timetable.

*... there has been a previous request that the 'surplus land' be sold due to lack of school use*

There has been no such request.

### **Long Term – Agree To The Community's Wish To Maintain Open Use Of The Land Or Find A Compromise**

- **Split The Land** *It is considered, by the community, that the school does not need the land.*

Whether the 'community' considers this is not the point – it is a matter for planning guidelines and the schools' needs to deliver the curriculum and educational experience safely. Had they not been so widely misinformed, they may have reached different conclusions.

#### **Conclusion**

*There is deemed to be no morally justifiable reason why the school should take all of this land as they already have significantly more soft play area than most schools and, leaving the land open to public access, will not affect the ability to expand.*

Again, use of the word 'take' in a statement about moral justification neglects the legal status of the land as school playing field, and implies the school is acting immorally.

The school may have more soft play areas than others (which may have sold it for development, or never had it in the first place), but that does not mean it should engage in a race to the bottom. The school currently has less hard play area than is recommended in guidelines for its size, and it will lose much of this to the new extensions to existing buildings. So appropriate size hard play areas will be made on current soft play areas, requiring the full extent of the school's fields to be used when there are 50% more pupils. This is explicit in the Chair's letters to parents, and was communicated to FGF by the Council at the meeting of 18<sup>th</sup> June, so to persist with this point is to wilfully ignore evidence and arguments which do not fit with the FGF narrative.

*That a temporary hold is put on the installation of the fence, for a period of 12 months*

This is possible, but would mean a halt to building 3FE expansion, which would impact the Council's ability to provide school places and local parents and children.

#### **Final notes from the School**

While we regret that an area of green space is being lost to the public, the School has always felt it was doing the right thing for local parents and on balance expansion is the correct decision. We do not share the view that, for example "*The park is too far away and the woods are not safe for young children*" (FGF website), and there are relatively recent 'new' green spaces on Allerton Grange Field, and we understand Gledhow Sports and Social Club allows access to its land. We have not engaged in an opposing media or public campaign, but staff and students of the school in the 1970s and 80s have confirmed all the school field was fenced (albeit with holes cut to gain access!) and we have had messages of support typified below:

Hi Mr Archer,

I've just seen the very well argued letter from the Chair of the Board of Governors. I just wanted to say that as a parent who reluctantly accepts the need for Gledhow to become a 3 form entry school I absolutely back you in the need to bring that part of the school's land back within school boundaries and keep it green.

If there is anything else we as parents can do, please let us know.

Dr John Willott  
Chair of Governors, Gledhow School



## **Results and Findings of a Survey, Petition, Research and Community Engagement Campaign by the Friends of Gledhow Field**



## Background

- The field behind Gledhow Primary School, (known locally as the 'Postage Stamp' or 'Gledhow Field'), will be fenced off this summer, (August 2015).
- The reason given is that there are plans for the school to grow from 2 to 3 Form Entry, (they will have an extra 7 classes, 1 per school year, which amounts to an additional 210 children), and, if that happens, the school would like more land for their expansion. This is subject to planning permission being granted.
- There are no legally binding restrictions on how much land a school must have therefore the school's expansion programme could go ahead without the additional land.
- Planning permission for the building programme has not been initiated at the time of writing and therefore the fence will be erected before a decision is made on the school's expansion.
- Although a public consultation phase was carried out in relation to the expansion of the school, there was no reference to the closure of the field on the Statutory Notices.
- Local neighbours and groups, including the Roundhay Planning Forum and the Gledhow Valley Conservation Area Group, were not informed of the impending changes.

## The Friends of Gledhow Field (FoGF)

- In line with recommendations made in the Roundhay Ward Neighbourhood Design Statement which is 'fully supported' by the council and has been adopted by LCC as a 'supplementary planning document', The Friends of Gledhow Field was established to ensure the survival of the field.
- As a result of the planned closure of the field, the group has engaged with local businesses, the police, other relevant organisations and, most importantly, the community to ascertain their views on the closure and their aspirations for the field. Research has included:
  - A petition which asks for signatures to 'save the field'
  - A survey
  - Communication, both formal and informal, with relevant individuals, groups and organisations on a local and national basis
  - Regular 'Litter Picks' to assess the quality of the land
- The research, (survey and petition), has been conducted online and on paper.
- The survey and petition have largely been promoted through word of mouth and via open public forums, social media etc.
- In addition, two groups of people were specifically targeted:
  - Families with young children of primary school age to ensure adequate consideration was given to those who have a direct interest in the school's expansion.
  - Local residents directly affected by any changes to the field, (i.e. those whose houses border the field).

# Statistical Results

## 1). Petition:

- More than 450 people have signed the 'Save Our Field' petition to date.
- Each signatory is asked to comment on their reason for supporting the petition and these comments can be read on the petition itself ([www.change.org/p/leeds-city-council-and-gledhow-primary-school-save-our-field](http://www.change.org/p/leeds-city-council-and-gledhow-primary-school-save-our-field)). A summary of these comments is added as an appendix to this document, (See Appendix 1).

## 2). Survey:

- 115 people were surveyed over a 4 week period.
- The survey asked questions about the community's views on the closure of the field as well as gaining their suggestions for improving the field in the future.
- Results of the survey are detailed on the following 3 pages.

*(Please note: Respondents were also asked about their views on all-weather pitches as, at the time, it had not been made known that the private organisation had withdrawn their interest. For future reference, should all-weather pitches be something that is explored at a later date, the results relating to this were as follows:*

- *When asked whether they would like to see all weather pitches on Gledhow Field, 91% of people said 'No'*
- *When asked whether they would be prepared to pay to use sports facilities on Gledhow Field, 93% of people said 'No'*

## 2). Survey (Continued)

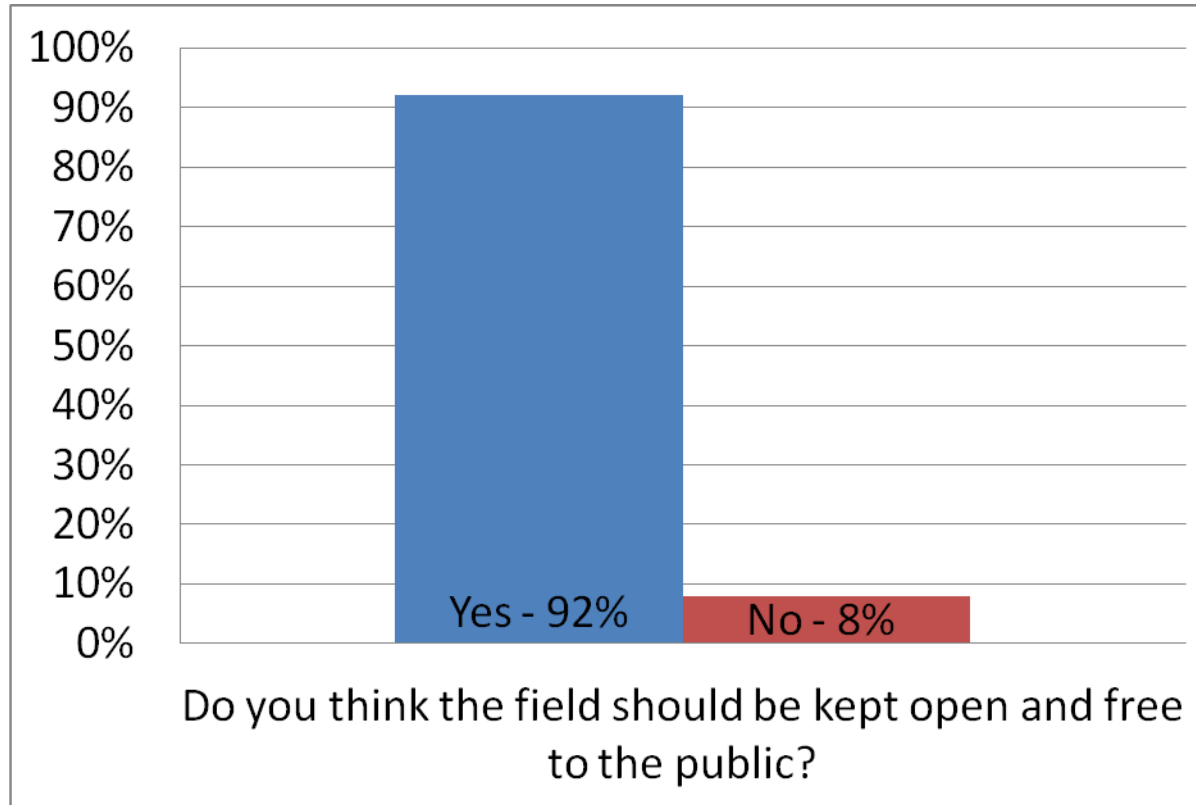

## 2). Survey (Continued)

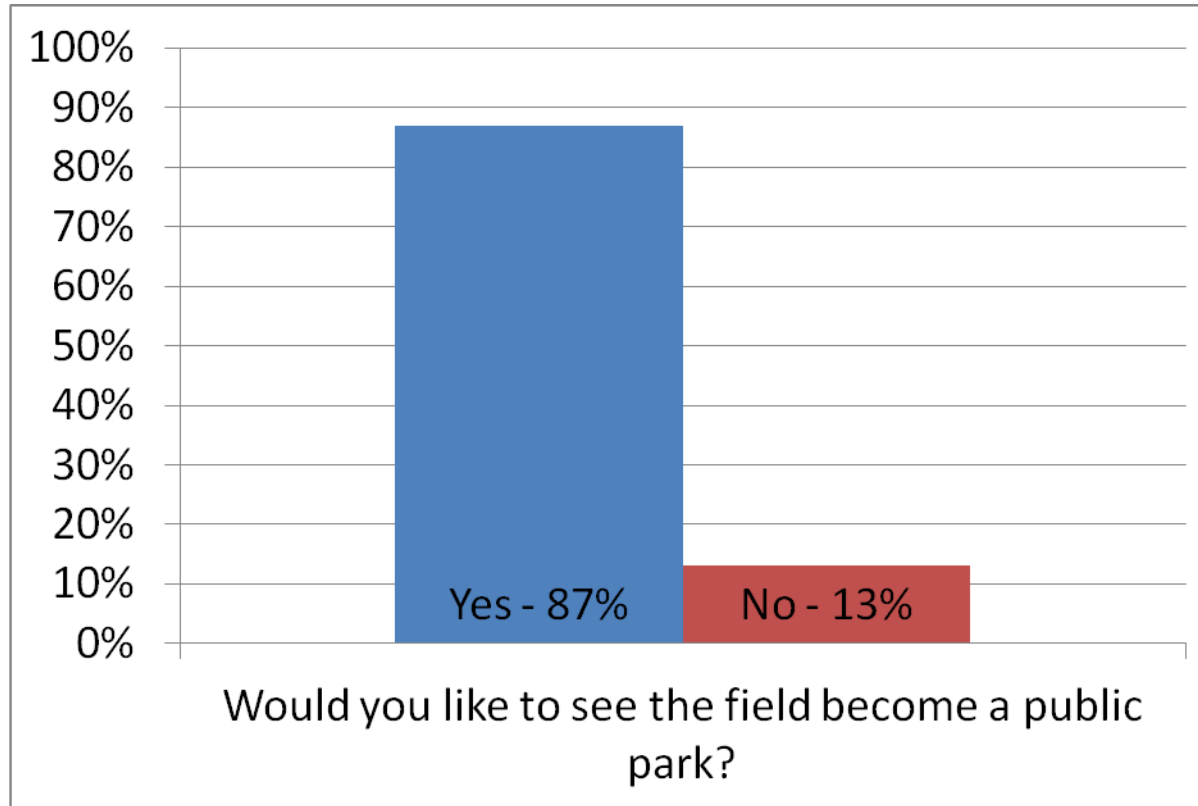



## 2). Survey (Continued)

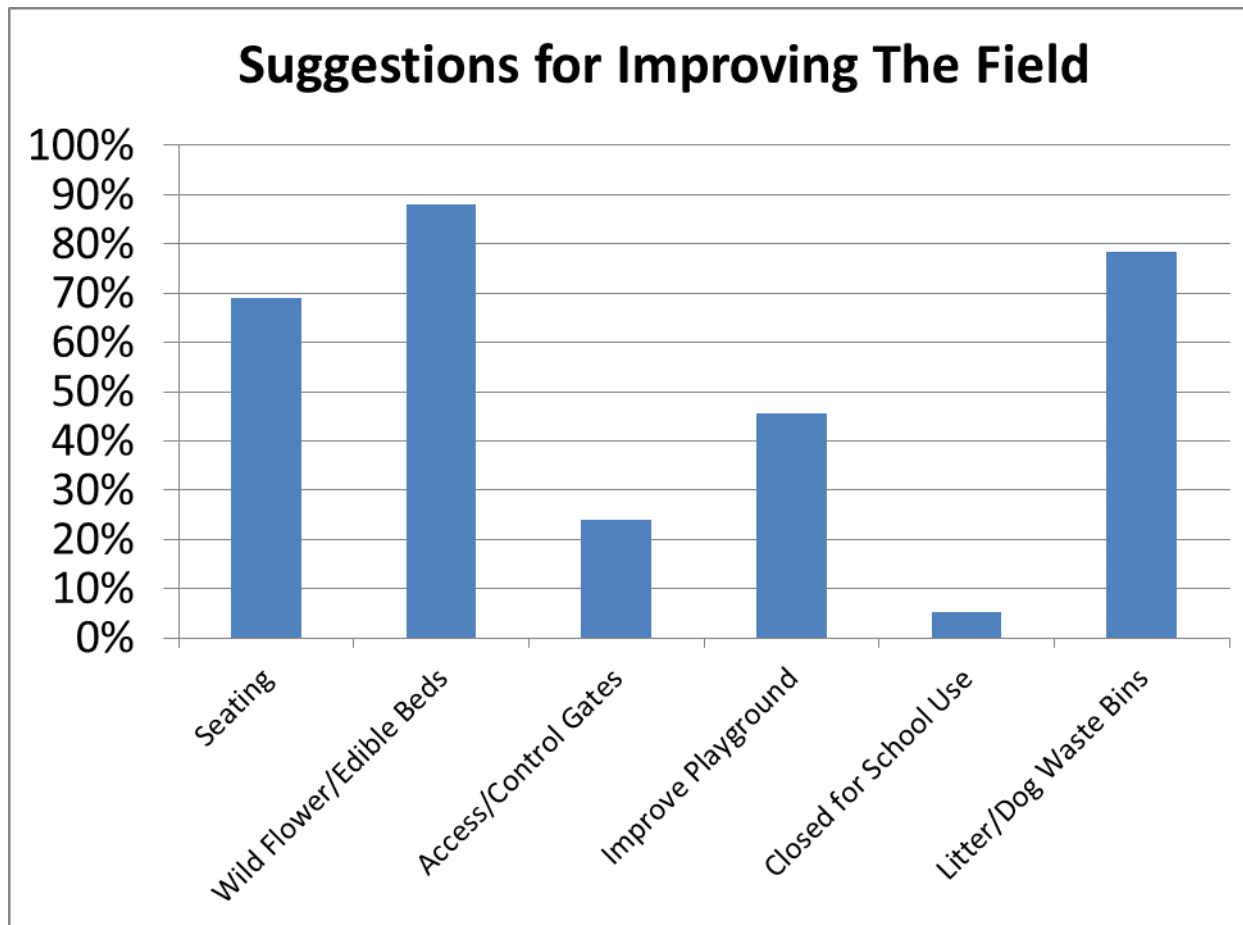

## Summary of Findings

The following is a summary of the findings, observations and the concerns raised via the petition, survey and broader engagement process.

### Green Space

- The field is a much loved, valued and used green space and the local community is almost unanimous in being against its closure.
- Many wanted the field to become a 'park' with paths, benches and formal flower beds etc whereas others were quite happy with it remaining as an informal recreation ground – both on the condition that it remained open to the public.

### Children's Play

- Without the field there is nowhere as safe and suitable for children to play.
- The field is used for football, learning to ride bikes and general play.
- Free play, (as opposed to adult led, structured sport), is essential for the development of a more rounded child.
- If the school expands, there will be higher numbers of children in the area before and after school times thereby increasing the likely use and requirement for open space to play in.
- Concerns were raised that by increasing the land for children to use in school hours, we are removing it from the same children's use after school, during the holidays and at weekends.

## **Social Inclusion**

- The field is currently used by older people, individuals with physical or learning disabilities and other vulnerabilities. Without this field, people who are unable to travel further will have no access to open green space for exercise, playing with young relatives, walking their dogs, socialising etc.
- Questions have been asked about what solutions will be put in place to ensure such groups of people are not socially excluded if this field is closed.

## **Lack of Engagement/Consultation**

- Almost every individual spoken to was not aware of the plans to fence off the land. Even parents at the school did not seem to have understood that the field would be lost to the public.
- There is considerable frustration and concern about the lack of consultation. As the land has been accessed, unimpeded, for decades, most assume that it is common land and that they should be consulted if this is to be taken out of public use.
- Even after being advised that the land is vested in education, as the land is owned by the council which is there to serve the public and paid for tax payers money, it is still largely felt that the community should have been consulted.

## **Health and Well-Being**

- The field provides one of few local amenities for exercise and fresh air.

## **Money**

Some felt that the fence did not represent good use of public money and that funds would be better spent either on facilities within the school or other council projects.

## **Crime and Anti-social Behaviour**

- Alternative play and open access areas, (specifically use of Gledhow Field), were solutions recommended by West Yorkshire Police in a court case resulting from anti-social behaviour on the Brackenwood Estate. Concerns are now being raised that this previously resolved issue, may reappear if local youths do not have open space to gather, kick a football around or generally let off steam.
- The field has not had any reports of crime on it, (according to [www.police.uk](http://www.police.uk)), the Care Home next door regards it as 'peaceful', they are not aware of any crime/anti-social behaviour, and the community generally considers the land to be free from social issues which is why it represents an important area for children and local residents to use safely.

## **Access**

- Access to the shops, woods, residential areas etc was a concern although it is accepted that a formal public right of way will be created.

## **Comparable Land**

- Several people commented on the school's significant existing land bank, many could not think of a single local school which has close to even half of the available playing soft play area that the school already has.

## **'Community' School**

- It was suggested that the school's 'community' status was questionable as they felt that by closing land to the public, they were not demonstrating a community ethos.
- It was also highlighted that school age children represent only one part of the community and that consideration should be given to its whole.

## **Access to Nature**

- In a compact residential area such as Roundhay, it is important for everyone, particularly children to have access to nature and green spaces as opposed to concrete and bricks.
- There are a number of interesting species on the land which should be respected and accessible by the public.

## **History**

- Whilst people accept change is needed, following the closure of the rugby ground, this is now the only green space left in the Gledhow/Brackenwood area. Local residents have used it for decades stretching back to the times when older members of our community remember cows on it. Things do have to move on, but we need to preserve a little bit of the past for our future generations.

## **Land Quality, Cleanliness and Safety**

- Volunteers in the community have conducted daily assessments, over a 4 week, period of the field including collecting litter and dog waste.
- The findings were that litter is not a significant issue, (indeed one political representative commented that there was more litter on the school field than on the open land.).
- Occasional social gatherings cause issues but there are already a number of responsible individuals in the community that clear the land, if necessary. (The addition of bins to the field might resolve this issue).
- Dog waste is a problem which needs addressing, (Bins might also help to resolve this).
- No needles were found.

## **Dogs**

- Closure of the field leaves many dog owners without a safe and accessible area to walk their pets. Around one in 4 households has a dog and it is estimated that there are around double the amount of dogs than children aged between 3 and 11 in the UK, therefore the importance of dog walkers as part of the community should not be underestimated.
- Walking dogs is a common form of exercise and is advocated by both the NHS and Public Health England as key contributor to the health and well-being of both adults and children.
- The field does have an issue with dog waste and this needs addressing.

## **The Fenced Path/Ginnel**

- Significant concern has been raised from both the community and the care home, (many of their staff use the land for access to work), about the safety of a path around the field. Currently the land is wide open with excellent visibility and regular use therefore it is deemed to be a safe route for children and adults alike. With a narrower path, it is thought the likelihood of anti-social behaviour, crime and drug use may increase on the land as visibility will be considerably reduced in this confined space. This has been highlighted to us by both the police, the Suzy Lamplugh Trust and other leading bodies who focus on crime prevention and personal safety.
- Questions have been asked about what plans are in place, (e.g. lighting and CCTV), to improve safety.

## **Community Socialising**

- The land is used by young and old people alike as a community area where they can meet, (planned or otherwise), get some fresh air and socialise. A sense of community is important and there is concern about crumbling social structures if there is no focal point such as the field.

## **Demand for Community Playing Fields**

- The concept of providing a community service for local sports teams and not-for-profit clubs is welcomed but there is a question mark over whether there is a demand for this. The Gledhow Sports and Social Club offers similar opportunities for such activities and there are concerns that by competing with them it could result in the loss of a further local amenity.

# What's the Answer?

## Short Term – A Temporary Stop on Erecting the Fence for Twelve Months

Putting on hold the current plan to enclose the field for 12 months will give the school, council, community and other relevant parties adequate time to review the decision and define a long term solution. The school will only have one extra class next year and, even though it has lost some of its land to the 'Reception Village', it will still have more than adequate space to fulfil the requirements of the school's Physical Education curriculum. (See appendix 2 which details the space within the school timetable for additional PE lessons).

Given that the council has already committed to proceeding '*at risk*' with the development of the reception village, at a cost of c£230,000, before the planning application has been granted, it would seem imprudent to spend further money on a fence for the following reasons:

- The school does not have planning permission to build, (and they are less likely to receive it if the field is closed), therefore it is feasible that extra land will not be needed. It is assumed that if the school remains as 2FE it would not need to enclose the field given that there has been a previous request that the 'surplus land' be sold due to lack of school use. The installation of the fence should be delayed until the outcome of planning is known.
- The decision to close the field to the public has been referred to the Scrutiny Board who may request a review of the decision to build the fence.
- Evidence has been gathered and an application for common land will shortly be submitted which could force the field back into public use and enforce the removal of the fence.
- In line with the Leeds 2030 'Best City' plans, which includes, as a priority, promoting '**good community relations**' and ensuring '**local people have the power to make decisions that affect them**', a full and proper consultation process is needed to adequately assess the school's need for the field balanced against the needs of the community. This could also overturn the current decision and would require the removal of the fence.



## **Long Term – Agree To The Community’s Wish To Maintain Open Use Of The Land Or Find A Compromise**

With such strength of feeling within the community, it would be unfair and unethical to continue with the current plans to close the field. The following solutions are suggested for consideration:

### **Solution 1 – The Field Remains open for Full Public Access**

That the council reassigns Gledhow Field as open ‘common land’ and it remains in full public use.

### **Solution 2 – The School and Community Work Together to Find a Mutually Beneficial Compromise**

The school is a key part of our community and it is important that, having succeeded in attaining ‘Outstanding’ status, they maintain that both for current and future pupils. However, the school is only a part of a much broader community and, with competing pressures for land within a growing city, the only way to deal with such pressures is by fair and equitable division of resources. Further consultation would be required to facilitate this but examples of ways in which both the school and the community could make best **shared use** of the land include:

- **Split The Land** It is considered, by the community, that the school does not need the land and, due to the topology of the land and drainage issues, parts of the field, without significant investment, will be useless to the school anyway. Therefore, a compromise would be to divide the area by fencing off a part for school only use, which would leave the remainder of the field for shared school and community use.
- **Fence Off A Central Sports Pitch Rather Than The Whole Field** - Our research demonstrates that the information regarding the proliferation of litter and needles has been overstated. Dog waste, however, is an issue, the addition of bins and signage may go some way to eradicate this, but sadly it is unlikely that some individuals within the community would respect an open field. The children’s playground is surrounded by a low gated fence with signs preventing access to dogs and this is respected. A similar approach could be used to fence off a sports pitch on the field which would allow the school to have an

extra sports facility when required, but would also maintain full public access to all except dog walkers when not in school use. Furthermore, a lower and shorter fence would represent a much needed cost saving for the council and would be less of an eyesore.

- **Shared Nature/Tree Planting/Wildlife Areas** – It seems clear that the school and the community actually want the same thing - a safe place for children and enhanced land for enjoyment of such as wildlife and other outdoor activities. As detailed in the statistical results, many of those surveyed were particularly impressed with the edible gardens in Oakwood and were keen to see natural enhancements to the land such as wildflower beds, tree planting etc which, according to the recent letter issued by the school, (dated 'June 2015'), matches with the school's aspirations and outdoor curriculum. Rather than excluding the public, why not work together to improve the land which could be enjoyed by school children **and** the broader community. Indeed there is even a financial incentive to work with the community as grants for certain projects are not accessible to public sector organisations, but would be to voluntary groups.
- **Considerably Increase The Width Of The Path Around The Edge** – Concerns about safety have been raised by the public and the care home. By significantly increasing the width of the band around the edge of the field this would address many of the community's concerns by:
  - Improving visibility and, therefore, safety.
  - Allowing sufficient space for children to play and dog walkers to exercise.
  - Reducing the cost of the fence.

# Conclusion

This report evidences that our community does not want to see the field closed, there is considerable objection against this and ideally it should be kept open for continued public use. There is deemed to be no morally justifiable reason why the school should take all of this land as they already have significantly more soft play area than most schools and, leaving the land open to public access, will not affect the ability to expand.

However, it is recognised that the school is an important part of the community and that the need for more school places in our region will put pressure on the current fenced off area. Our recommendations are therefore:

1. That a temporary hold is put on the installation of the fence, for a period of 12 months, until the summer of 2016 to allow for planning permission to go through, the scrutiny panel to make their decision etc and to give time for an effective consultation programme.
2. That an independent working party is formed comprising local stakeholders, (parents, community school governors, local residents, FoGF, The Gledhow Valley Conservation Area Group, The Roundhay Planning Forum etc), with a view to working together to formulate a mutually agreeable proposal which would satisfy the needs of both the school and the wider community.

## Appendix 1 Summary Of Comments From Petition

### The Following Is A Sample Of The Views Of Our Community, Taken Directly From The Petition

This is the last & only green space in this area where anyone can safely take their children or grandchildren to let off steam & have a run around or play games.

This field is always used by the local people, and has been for many years. Both friends, dog walkers and children all use the field and it would be a huge shame to see it go

I think it's absolutely crucial for children to have safe places to play. They have to spend far too much time sitting down, which is no good for emotional, physical, social or intellectual development.

I have used this field and played on it when young, taken my own 4 children when young on here for picnics, football and been able to let them run around and play safe and I also still use to it meet up with other members of the community, take my granddaughter and take my dogs on here

Grown up in the area and this holds many childhood memories. Perfect place for children, dog walkers, and many more

This field also provides a very fast short-cut from Londis shops to the path in the woods down to Little Switzerland!!! I USE IT ALL THE TIME it saves at least 15 minutes when walking from Gledhow to Chapel Allerton!!!

I've used this field for the last 25 years every day with my children/grandchildren, dogs and childminded children. Sure this appeal will go nowhere little voices don't count but protesting anyway

I'm signing because green spaces are essential for the general health and wellbeing of the public

To enable the local people to enjoy the field as they have the last 20 years.

We need to preserve this green space now and for future generations.

Take away these spaces and kids just end up walking the streets bored and causing trouble, or sat at home playing computer games and getting obese!!

We access this park frequently and losing this means no outdoor for me or my children

I love this field. I can walk through it every day to get to the bus stops on Brackenwood Drive. I can pick blackberries there in the autumn. People walk their dogs here. Kids play football. Please leave this as a field.

<p>Leeds, West Yorkshire has always had Green Belt for our Community to enjoy it's hard enough trying to occupy children during the six week holidays as it is, this field represents the whole of our Community surely that means something to our Council Representatives? Fields &amp; Sports go hand in hand, were will the children go if the field is swallowed up? The children that use this field constantly to train and keep fit deserve somewhere safe to enjoy their chosen sports. Fresh air and regular exercising is the way forward, families enjoy training together it's a "no-brainer" surely!</p>
<p>Gledhow School already have one of the larger open-fields available for students in the area, so why expand it when this would take away one of the major areas for local dog walkers in the area who may not want to go into the woods? It is also a centre point for people wishing to cross from Gledhow to Brackenwood and vice versa, and the fact that it is behind so many houses will just serve as a hindrance to those around it. In short, expanding Gledhow's already vast playing fields will serve to devalue the surrounding area as locals will lose yet another 'green' and open space that positively effects many lives.</p>
<p>There is nowhere to go sit and have a picnic , nowhere to take the little ones , not everyone has got a car and can travel , it's a close knit community and keeps the children off the streets, my grandchildren use it, so I know it's well used</p>
<p>I walk my dog on this field every morning as many others do, there is nowhere else, I also have taught my two eldest to ride their bikes on here and I am intending to teach my youngest too, it would be a shame to lose this field, there are not many left.</p>
<p>We need to preserve our green spaces for everyone, not just for the few. There are no playing fields for the local kids until you get to Roundhay Park, which is a long way from Brackenwood. I think that the vandalism rates will go up if this little haven goes.</p>
<p>The local authority and the school show no sign of taking into account the impact on local residents of their proposal for the field, and appear not to see the need for any kind of consultation process. Apparently the fact that the planners and legal advisers to the Council support the scheme is good enough.</p>
<p>I agree we need accessible and safe open spaces within the community for our children to play and for all age groups to enjoy.</p>
<p>I live in the area play football with my child on the field and feel that it is part of the community and the field should be used as part of community for children to reduce crime</p>
<p>Live locally and we need green spaces in our community for the community! Once it's gone it's gone...</p>
<p>Kids need a field.</p>
<p>Green space is a valuable asset to every community that should be entitled to.</p>
<p>People must have somewhere natural to breathe some fresh air and to take a break from the built environment!</p>
<p>It is important that we retain such green spaces for the future for all to enjoy.</p>
<p>I live just around the corner from this field and lived directly behind it until I left home. I played on it as a child/adolescent and now my son plays on this field and is learning to ride his bike on it.</p>
<p>Through my time growing up in Brackenwood the field has been a place we could all group up and play huge football games without being in fear of breaking anything, getting the police called and just having a good time. It is also freedom for my Dog to run around and also to do some fitness of my own. We need this field</p>

This affects my grandchildren, it's their heritage
Good field, good shape, has hilly regions, lots of grass, trees, bordered by nettles, a top field in general!!
The 'haunted' house next to it was even better! But that is long gone now sadly :(
I'm signing because I use the field out of convenience every day on my way to work and I love to admire the evening sunset on my way back home from work. I also like to sit in the field every now and then to get away from life's troubles. I really do hope we can save this field!
There's nowhere for kids to go these days creating boredom which leads to crimes. The government doesn't need more crimes!
It's the last open space accessible by the public in the locality
EVERYONE needs green space to run, walk, play, and breathe fresh air. When it's gone it's gone and will never be the same again.
If the children could have free access to sports facilities on an evening I'd support this. Creating a "rat run" round the edge of the field and removing the last free green space in this area is not fair on the local children.
I belong to the Gledhow Valley Conservation group and this is an important issue to all regarding keeping our green spaces, especially ones that can be used for the general public. We must try to preserve this unique pocket of land not only for ourselves, but for the generation to come.
This field is fine as it is, just needs mowing from time to time, that is all. Most fields associated with schools have no access on an evening and before we know it that could happen to this field too-where can children play, except on the street where it isn't that safe now due to cars always being in a hurry. The school can still use it for Sports Day enclosing it with a fence restricts who can use it and when. Fields like this one are spaced out within neighbourhoods to give everyone an area where they can get out to enjoy fresh air and sunshine. I've not heard of any major problems with nuisance visitors to the field, so why do the school and council want to change things?
This has been a long established series of footpaths since the Brackenwood estate was built in the 1950's-1960's. It constitutes a public right of way, and is also the last green space in the whole area.
A lot of people that live in Gledhow do not have a garden. Therefore this is the only safe place for children, pensioners and disabled people to go to play or for some peace and quiet.
This field has been in continuous public use since before Gledhow School was built and I believe it is protected by a Covenant made by Miss Kitson who previously owned the field. I and my family have used it for at least 45 years.
Where else am I going to walk my dog and meet with other members of the community? The field has an important for building community spirit

## Appendix 2 School Timetable

The following table has been compiled from information taken directly from the school's 2014/2015 timetables published on their website. This demonstrates that the school currently has facilities to have at least 3 PE lessons at any one time. This gives them 60 lesson slots per week, (3 slots per lesson x 4 lessons per day x 5 days per week). Currently 24 slots are filled, a further 12 would be needed when the school reaches its maximum capacity, (630 pupils) therefore a total of 36 slots filled. If they had one less sports pitch, (through loss of land due to building), meaning one less slot per lesson, they would still have 40 slots which would be sufficient to accommodate the 36 lessons required. (This does not take in to consideration swimming lessons which are done off site and therefore the actual slots used onsite are less than the figures quoted).

<b>Gledhow Primary School – Timetabled PE Lessons 2014/2015</b>				
	Lesson 1	Lesson 2	Lesson 3	Lesson 4
<b>Monday</b>		Year 4 Swimming/PE	Year 4 PE	Year 4 Indoor PE
		Year 4 Swimming/PE	Year 5 Swimming	Year 5 Swimming
			Year 5 Swimming	Year 5 Swimming
<b>Tuesday</b>	Year 1 PE & English	Year 2 Outdoor PE	Year 6 PE	
<b>Wednesday</b>			Year 1 Outdoor	Year 3 PE
			Year 3 PE	
<b>Thursday</b>			Year 2 PE	Year 1 Outdoor PE
			Year 3 PE	Year 2 PE
				Year 6 PE
<b>Friday</b>	Year 3 Outdoor PE	Year 2 PE	Year 1 Indoor PE	Year 6 PE
			Year 6 PE	

**This report was prepared by the Friends of Gledhow Field for presentation at a meeting on Monday 13<sup>th</sup> July 2015 to the school, Local Councillors and LCC staff.**

**The report will be published on the FoGF website, via various social media sites and will be available to anyone who should request it.**

**It is requested that, in the interests of openness, the report is copied to all School Governors and published on the website of Gledhow Primary School.**

**The report has been compiled from the views and opinions of petition signatories, survey respondents, the local community and a number of other relevant organisations. The views are not necessarily the views of the authors. Further information has been sought from other sources, including the School and Council, and is believed to be correct at the time of writing. If you spot any errors in this report or believe any of the information to be incorrect, please contact The Friends of Gledhow Field via email: [info@friendsofgledhowfield.org](mailto:info@friendsofgledhowfield.org)**

**The Friends of Gledhow Field have only surveyed the community on the subject of Gledhow Field itself, not on the school's expansion plan and therefore we are unable to express a view on this. However, it should be made clear that, individually, the founding members recognise the urgent need for school places and are not opposed to the expansion of Gledhow Primary School.**





## Briefing Note

- Gledhow Primary 3FE Expansion land issues  
24<sup>th</sup> June 2015



## Author

- Chris Gosling (Development Officer)  
Built Environment Team

## Basic Need Programme

**Subject:** Gledhow Primary 3FE Expansion land issues

### Summary

In June 2014, permanent expansion of Gledhow Primary School from 2016 was proposed and accepted by the school. The key criteria for the Governing Body accepting this proposal was a combination of assurances that the 'ethos' of the school would be crucial to the design imperative and that the school land outside of the fence line, currently open though maintained by school, would be rationalised as part of the move towards a larger three form entry campus. The land is vested with education and local residents are now objecting to the proposed change of use. Due to the accelerated expansion, with the 3FE intake being brought forward from 2016 to 2015, the field is now required to be secured for school use from September 2015.

### Background Information

- The concept drawings tabled at the public consultation process held in July 2014 proposed to utilise the field as part of the expansion, no comment was made on this point by attendees.
- Prior to 1996 the field was used in its entirety, following the Dunblaine incident a programme of safeguarding works took place to secure the perimeter. The entirety of the field could not be fenced due to financial limitations at the time. The school have continued to undertake grounds maintenance on the entirety of the field.
- Between 1983 and 2006 a local rugby club leased the field from Gledhow Primary School, following the construction of a new club house they vacated the lease resulting in a Section 106 allocation for the betterment of the Gledhow field. This equates to approximately £22,000 and is currently unspent; the terms of the agreement dictate that after 10 years the monies will need to be repaid if not allocated. This deadline is May 2017.
- The field is owned by Leeds City Council and vested with education, no restrictive covenants are in place and the field itself has no planning protection. No planning application is required for the fence as it is less than two metres high, a discussion has been held with the Planning Officer on this point.

### Current position

- Temporary accommodation will be provided this summer to allow a bulge cohort to be placed in Reception from September 2015. The requirement to utilise the field is therefore even more pressing, as from September 2015, part of the current field will be utilised by decant accommodation and, later in the year, the construction compound.
- The fence proposals allow for a 4 to 5 metre gap to be maintained between the field and the adjacent property line, this will maintain the informal short cut through the field currently in use.
- A local residents group, 'Friends of Gledhow Field', have since been established to prevent this change of use and have been petitioning local residents to oppose these proposals. A discussion has been held with local ward members, who were in full attendance, and the 'Friends of Gledhow Field' to discuss these points. Local ward members remain supportive of the proposals but wish to work with the local community to reach a mutual consensus.

- The Governing Body have committed to supporting the local community by offering usage of the field out of school hours via the normal lettings procedure at no cost to 'not for profit' / groups.
- Governing Body support for the expansion and the bulge cohort will be removed if the field is taken out of the proposals. The requirement for additional team sports pitches was a critical driver for them accepting the expansion. Safeguarding of this area cannot be assured without the fence line in place.
- In order to support the full expansion, and the interim construction period including the 'bulge cohort', it is essential that the field is fenced off and secured for education use. This work needs to be completed during August 2015; therefore it is essential that an order is placed at the earliest opportunity to meet these critical dates.

## **Appendix**

- Appendix A - Current site plan
- Appendix B - Proposed fence line

APPENDIX A - CURRENT SITE PLAN

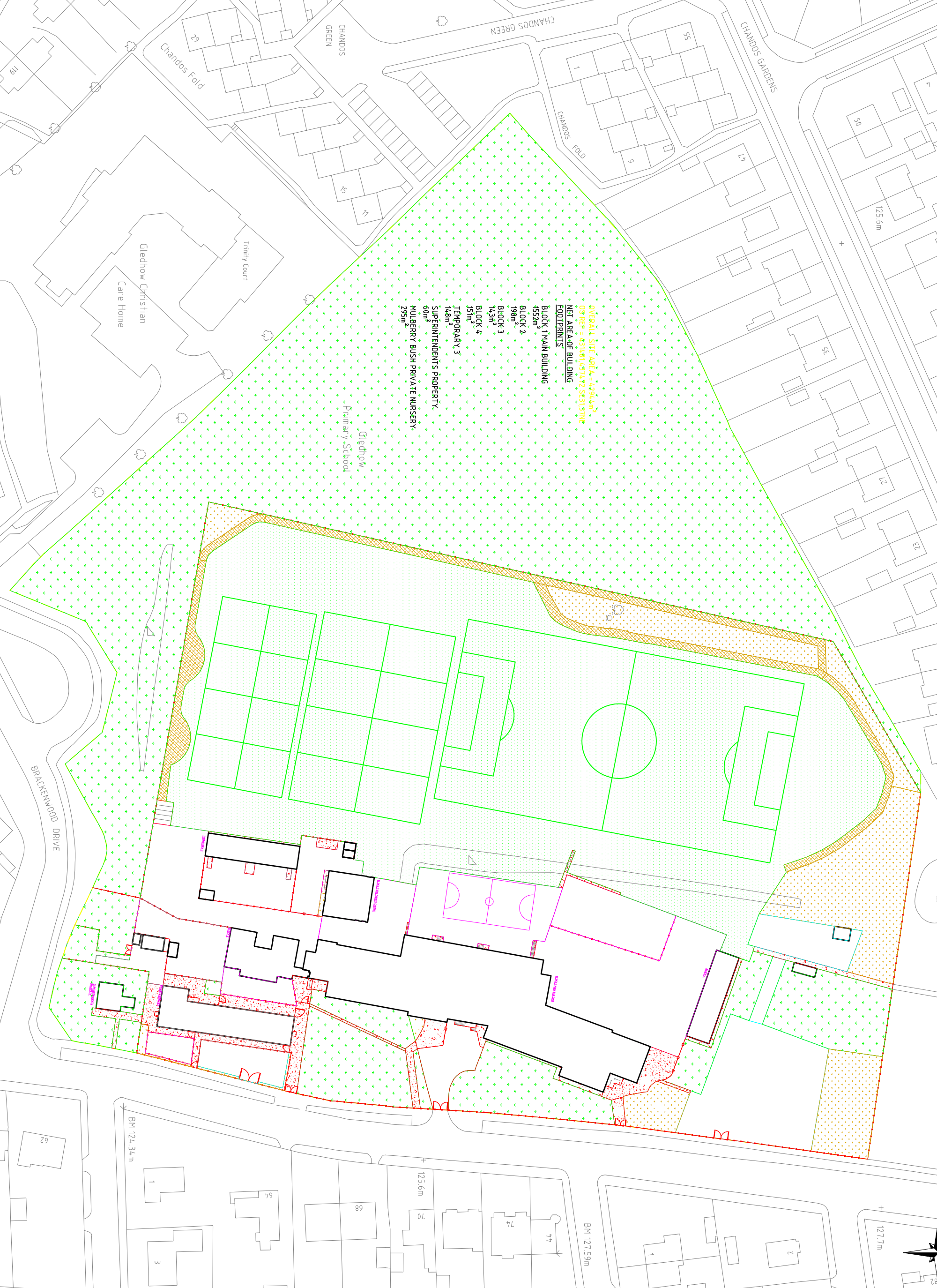

Any queries regarding these drawings should be made to Children's Built Environment  
Tel 0115 247 5352

REV	DATE	DESCRIPTION
02	RC	DCI 2014 OS area around private nursery updated.
01	RC	NOV 2011 Block 2 & 3 added, OS Stamp modified.

© Crown Copyright and database right 2014  
Ordnance Survey LA100019567

**DO NOT SCALE**  
This drawing, including the design and technical information contained on it, is the copyright of Leeds City Council. No drawing may only be used for the specific purpose for which it has been produced and may not be reproduced or copied without the permission of Leeds City Council.



**PROJECT:**  
ASSET MANAGEMENT INFORMATION

**SITE LOCATION:**  
GLEDHOW PRIMARY

**DRAWING TITLE:**  
SITE LAYOUT

**DRAWN BY:**  
P.G.S.

**REVISIONS:**  
BUILT ENVIRONMENT  
CHILDREN'S SERVICES  
PO BOX 837  
LEEDS CITY  
LS1 9PZ

PRODUCTION No.	DATE	PLAT SIZE	SCALE	REV
2428	OCT 2014	A1	N.T.S.	02

This page is intentionally left blank

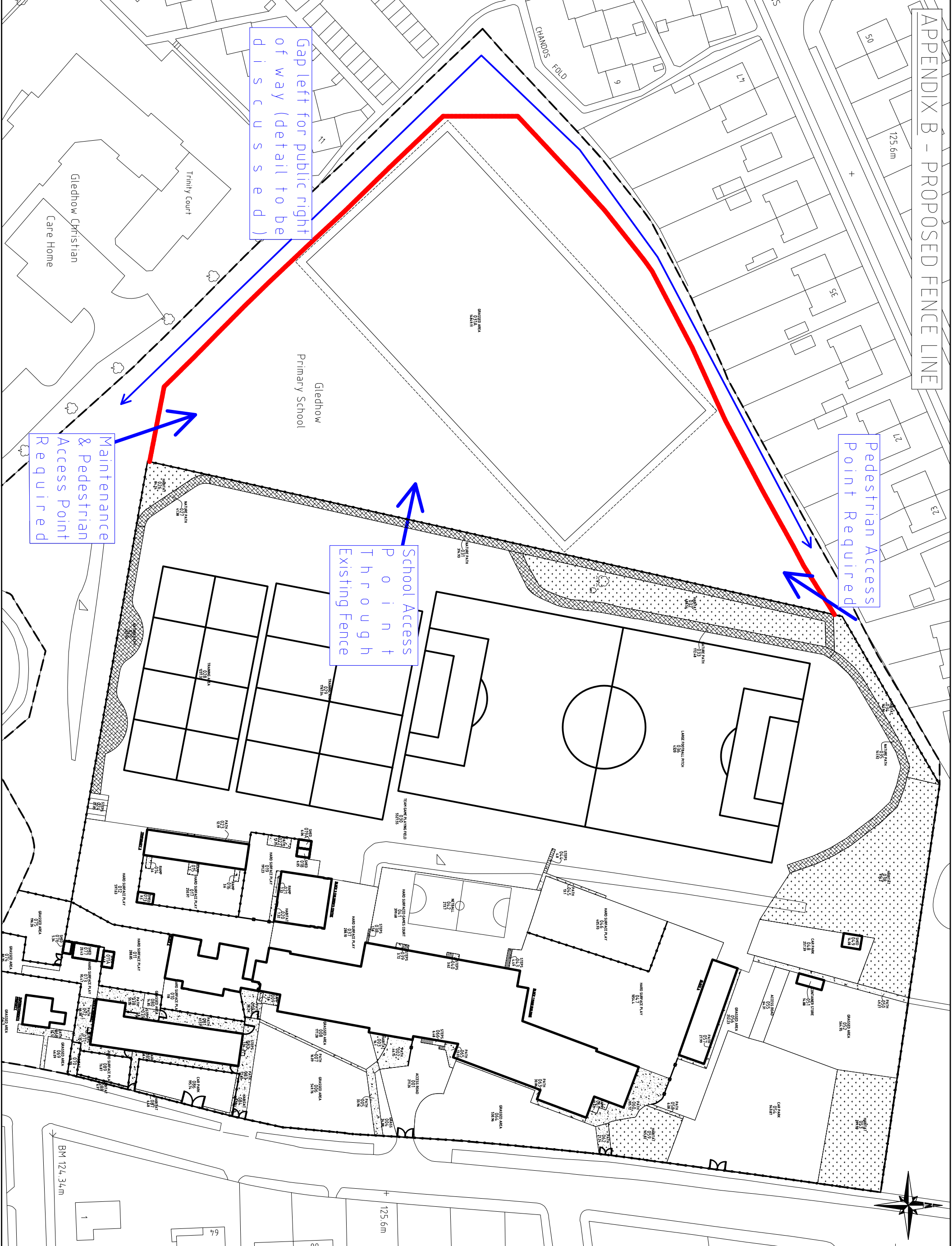

Any queries regarding these drawings should be made to Children's Services Built Environment  
Tel 0113 247 5352

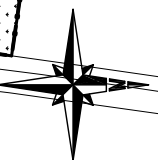

REV	DATE	DESCRIPTION
02	02 OCT 2014	OS error enclosed private nursery modified.
01	01 NOV 2013	Block 2 & 3 added, OS Stamp modified.

© Crown Copyright and database right 2014  
Ordnance Survey LA100019567

**DO NOT SCALE**  
This drawing, including the design and technical information contained on it, is the copyright of Leeds City Council. No drawing may be used for the purposes of any contract or agreement with Leeds City Council without the prior written permission of Leeds City Council.



<b>ASSET MANAGEMENT INFORMATION</b>	
PROJECT	BUILT ENVIRONMENT CHILDREN'S SERVICES
ASSET LOCATION	GLEADOW PRIMARY
ASSET TITLE	SITE LAYOUT
ISSUED BY	P.G.S.

<b>BUILT ENVIRONMENT CHILDREN'S SERVICES</b>			
PO BOX 837			
LEEDS CITY			
LS1 9PZ			
ISSUED BY	DATE	SCALE	REV
2428	OCT 2014	A1	N.I.S. 02

This page is intentionally left blank

## Gledhow Primary School Expansion - Consultation Timeline and Summary

- A public consultation took place between 30 June and 25 July and included meetings with governors, staff, children, residents and parents.
- Three drop in sessions took place for parents and residents to learn more about the proposal. These were advertised via a leaflet drop in the area (321 local residents), banners on the school fence, LCC website and Wordpress. Parents also received a letter about these. Dates as follows:
  - 30<sup>th</sup> June 2014 at 8:30am
  - 9<sup>th</sup> July 2014 at 18:00pm
  - 15<sup>th</sup> July 2014 at 14:00pm (Sports Day)
- All drop-ins were well attended with a mixture of parents and residents, with one taking place during a sports day to ensure effective engagement.
- We attended staff and Governor meetings as follows:
  - Governing Body on 7<sup>th</sup> July 2014 at 18:00pm
  - Staff Meeting on 14<sup>th</sup> July 2014 at 15:30pm
- 17 responses were received, as follows:
  - 9 supported the proposal, although some concerns were raised about traffic. Some comments were made about ensuring the triangle of land is used to expand the school so it does not have a negative impact on school site.
  - 8 objections were received, the concerns were parking and traffic, the school being too large at 3 forms of entry and losing the character of the school. One objection stated more dog fouling will occur in the area if the field at the back of the school is taken away from the community.

This page is intentionally left blank



**Report of Director of Children’s Services**

**Report to Executive Board**

**Date: 17 December 2014**

**Subject: Outcomes of statutory notices to increase primary school provision in Roundhay**



Are specific electoral Wards affected? If relevant, name(s) of Ward(s): Roundhay and Moortown	<input checked="" type="checkbox"/> Yes	<input type="checkbox"/> No
Are there implications for equality and diversity and cohesion and integration?	<input checked="" type="checkbox"/> Yes	<input type="checkbox"/> No
Is the decision eligible for Call-In?	<input type="checkbox"/> Yes	<input checked="" type="checkbox"/> No
Does the report contain confidential or exempt information? If relevant, Access to Information Procedure Rule number: Appendix number:	<input type="checkbox"/> Yes	<input checked="" type="checkbox"/> No

**Summary of main issues**

This report contains details of a proposal brought forward to meet the local authority’s duty to ensure sufficiency of school places. The changes that are proposed form prescribed alterations under the Education and Inspections Act 2006. The School Organisation (Prescribed Alterations to Maintained Schools) (England) Regulations 2013 and accompanying statutory guidance set out the process which must be followed when making such changes. The statutory process to make these changes varies according to the nature of the change and status of the school.

In this case the school, Gledhow Primary School is a community school, the proposer is the local authority. At its meeting in September 2014 the Executive Board gave permission for the local authority, as proposer, to publish a statutory notice. The notice was published on 26 September 2014 and expired on 24 October 2014. It provides the opportunity to make representations regarding the proposals. One representation was received during the statutory notice.

As the representation objected, the School Organisation Advisory Board (SOAB) was convened to consider the matter and make a recommendation to Executive Board. SOAB met on 13 November, the notes of their meeting are attached at Appendix 1.

The report details the representation received in response to the statutory notice and seeks a final decision from Executive Board.

Under the Education and Inspections Act 2006 a final decision must be made within two months of expiry of this notice, therefore by 23 December 2014, or be referred to the School's Adjudicator for a decision. Any significant change to the proposal at this stage would require the proposal to be rejected, and fresh consultation to begin, precluding the delivery of places for 2016.

## **Recommendations**

Executive Board is asked to:

- Approve expansion of Gledhow Primary School by increasing its capacity from 420 pupils to 630 pupils, increasing the admission limit in reception from 60 to 90 from September 2016
- Note the responsible officer for implementation is the Capacity Planning and Sufficiency Lead

## 1 Purpose of this report

- 1.1 This report contains details of a proposal brought forward to meet the local authority's duty to ensure sufficiency of school places. The report describes the outcome of a statutory notice in relation to the expansion of primary provision in Roundhay for September 2016, and seeks a final decision on the proposal.

## 2 Background information

- 2.1 At its meeting in September 2014 the Executive Board considered the outcome of consultation on a proposal to expand Gledhow Primary School from a capacity of 420 pupils to 630 pupils, increasing the admission number from 60 to 90 pupils with effect from September 2016.
- 2.2 Executive Board gave permission to publish a statutory notice on this proposal, which was brought forward under Education and Inspections Act 2006 and in accordance with the School Organisation (Prescribed Alterations to Maintained Schools) (England) Regulations 2013. The notice was published on 26 September 2014 and expired on 24 October 2014. A final decision must be made within 2 months of the expiry of the notice, therefore by 23 December 2014. The Executive Board is the decision maker for this proposal.

## 3 Main issues

- 3.1 One representation was received, which objected to the proposal. Where objections are received School Organisation Advisory Board (SOAB) is convened to consider the matter and make a recommendation to Executive Board. SOAB met on 13 November, the notes of their meeting are attached at Appendix 1.
- 3.2 The governing body confirmed that they support the expansion of the school to 3FE in principle and are closely engaged with the consultation and design process for the new school accommodation. Their guiding principles in terms of design for the new build are that the design provides the environment in which to maintain the delivery of the full curriculum and their status as an "outstanding" school, allows for safe and effective movement throughout the new school, has sufficient hard play area and the full range of facilities to ensure that ethos of the school will not be detrimentally affected.
- 3.3 The issues raised in the objection are outlined in the following paragraphs.
- 3.4 **Concern:** The school has a friendly and close atmosphere which is commented on by Ofsted, and the children feel cared for. This might be eroded with a larger school.
- 3.5 **Response:** The headteacher and governing body are very keen to retain the ethos of the school and are confident that they would manage any changes successfully without losing the close personal relationship with all pupils.
- 3.6 Support would be provided by the Learning Improvement Team at Leeds City Council to assist them in managing the change process. They would also be able to draw upon the experience of other schools that have expanded from 2 to 3 form entry. Contact has already been made with the Headteacher and leadership team

of Westerton Primary School which also expanded from two to three forms of entry and is an outstanding school.

- 3.7 Research indicates that size is not the determining factor as regards to those schools which are successful. The quality of teaching and learning and of leadership and management are the key drivers for success. Gledhow Primary School benefits from both of these. There is no evidence to suggest that the expansion would have a negative impact upon the education of the pupils.
- 3.8 **Concern:** There are concerns over the disruption and health and safety issues from the required construction work.
- 3.9 **Response:** The building project would be carefully managed to ensure the health and safety of children. Whilst it is not always possible to do all building work during school holidays, any works that are likely to be very noisy or disruptive would be carried out as far as possible whilst pupils and staff are away, whilst also minimising disruption for residents. Any building work carried out while the school is open would be completely segregated from the pupils and staff to ensure safety, and minimise disruption to teaching and learning.
- 3.10 **Concern:** More traffic would mean that the chances of someone being injured or even killed would be increased. It is also likely to increase the issues with roads and drives being blocked and confrontation between drivers such as fighting over parking spaces.
- 3.11 **Response:** It is acknowledged that there are some traffic issues in the vicinity of the school and particularly at peak times e.g. the beginning and end of the school day, and that expansion may increase traffic to the school. However this proposal is designed for local children, minimising this impact as far as possible.
- 3.12 Highways and Planning departments have been engaged in the initial design work for the new accommodation. If the proposal progresses any building work would be subject to the normal planning permission process. The Highways Department is a statutory consultee on all planning applications and therefore officers would formally comment on this application. Any measures identified as a requirement for approval would be incorporated in the scheme of works. In addition a green travel plan would need to be developed by the school focusing on encouraging journeys on foot to school.
- 3.13 **Concern:** Dog fouling on streets and near the school is already an issue, especially as there is a field at the back of the school used predominantly by dog walkers. The current plans are to bring this field back into school use, which may mean that there is less dog fouling close to the school. However it will probably mean that there is more fouling in the street surrounding the school, as the field will no longer be able to be used.
- 3.14 **Response:** The space in question is land which is already part of the school site and it is maintained by the school but not currently fenced in as part of the school site. Any issues on the land or surrounding areas relating to dog fouling should be reported to the Local Authority as dog fouling is not permissible and is a fineable offence.

- 3.15 **Concern:** The current plan is to build new classrooms etc. on part of the school playground. Although this loss would be compensated by bringing the field back into school use, this could not be used when wet. I understand that there are plans for some of the current field to be converted to an all-weather play area.
- 3.16 **Response:** The land lends itself to sports usage by the school and it would provide additional green space for school use. Some outdoor hard play area would be lost due the construction of additional school accommodation, however any play space used to accommodate new buildings would be re-provided elsewhere on the site. The school have been keen to ensure the plans for the new school accommodation include sufficient and appropriate play space for the children. The site is sufficiently large to accommodate the additional buildings and there is sufficient hard and soft play space for a 3FE school, in line with Department of Education guidelines.
- 3.17 **Concern:** Do not agree with increasing the number of primary school places available in the Roundhay area, if there are then also no plans to increase the numbers of secondary school places available. The demographic data clearly shows that the area of most need is around North Roundhay/Street Lane where Talbot Primary School is the nearest primary school. This will expand the catchment area and just seems to be the cheapest and easiest option, but not the best one for the longer term.
- 3.18 **Response:** Although it is acknowledged that there is a particular issue for children for whom Talbot Primary School is their nearest school, it is not currently possible to expand that school. The expansion of any provision will impact on the patterns of distribution of pupils, but the expansion of Gledhow Primary School would address the need for additional places in the immediate area they live in.
- 3.19 As larger cohorts move through the primary schools, there will be a need to expand secondary provision across the area and plans will be brought forward.

## 4 **Corporate Considerations**

### 4.1 **Consultation and Engagement**

- 4.1.1 Consultation was managed in accordance with all relevant legislation and local good practice. The notice was publicised in the Yorkshire Evening Post and copies were placed on all the school entrances. The full proposal was placed on the school and council website.
- 4.1.2 A banner was placed on the school gates/fence to raise awareness of this phase in the statutory process. A survey was set up using Leeds City Council's Talking Point to enable stakeholders to make comments about the proposals. Stakeholders also had the opportunity to make comments in writing, by letter or by email.
- 4.1.3 Ward members were formally consulted during the public consultation stage and were offered the opportunity to comment at statutory notice phase. No concerns were raised.

## 4.2 **Equality and Diversity / Cohesion and Integration**

4.2.1 The EDCI screening form has been completed and was attached as an Appendix to the Executive Board report of 17 September 2014. It is therefore not attached to this report.

## 4.3 **Council policies and City Priorities**

4.3.1 The proposal has been brought forward to meet the Council's statutory duty to ensure there are sufficient school places for all the children in Leeds. Providing places close to where children live allows improved accessibility to local and desirable school places, and thus reduces the risk of non-attendance.

4.3.2 A key objective within the Best Council Plan 2013-2017 is to build a child friendly city with a priority, 'Ensure sufficiency of school places'. The delivery of pupil places through Basic Need is one of the most basic entitlements of a Child Friendly City. A good quality school place contributes to the achievement of targets within the Children and Young People's Plan such as our obsession to 'improve behaviour, attendance and achievement'. Gledhow Primary School was rated as 'Outstanding by Ofsted at its most recent inspection.

4.3.3 In addition, "Narrowing the Gap" and the "Going up a League" agenda are fundamental to the Leeds Education Challenge. A key area of monitoring in primary schools is the key stage 1 to 2 value added scores. The score relevant to the schools contained in this report is

- Gledhow Primary School 100.6 (Top 40% nationally)

## 4.4 **Resources and value for money**

4.4.1 The budget for this proposal is £3.91m. The project is intended to meet the local authority's sufficiency duty and the build costs would therefore be met by the local authority. Should the proposal be approved a planning application and request for authority to spend would be put in place.

## 4.5 **Legal Implications, Access to Information and Call In**

4.5.1 The processes that have been followed are in accordance with the School Organisation (Prescribed Alterations to Maintained Schools) (England) Regulations 2007, and amended by School Organisation (Prescribed Alterations to Maintained Schools) (England) Regulations 2013.

4.5.2 This report is not subject to call in due the critical nature of the date by which an Executive Board decision must be made. Executive Board must make a decision within two months of the expiry of the statutory notice period, otherwise the proposal must be referred to the School Adjudicator for a final decision. The statutory notice period closed on 24 October and therefore a final decision must be made by 23 December 2014. If a decision is not made, then the additional school places required for 2016 will not be secured.

## 4.6 Risk Management

4.6.1 The statutory time limit for a final decision on each of the proposals detailed in this report is 23 December 2014. The proposal to increase primary provision in Roundhay has been brought forward in time to allow places to be delivered for 2016. Any significant change to the proposal at this stage would preclude the delivery of places for 2016, and the authority's ability to meet its statutory duty for sufficiency of school places in the short term may also be at risk. It should be also be noted that sufficiency of school places features within the council's corporate risk register.

4.6.2 A detailed risk register would be established and would be maintained for each project if approved. It is necessary to progress feasibility design work at risk during the statutory notice phase; however the decision to proceed to detailed design stages would not commence until a final decision has been made. Any delay to the statutory process would increase the risk of delayed delivery of the building solution or financial risk of abortive fees being incurred.

## 5 Conclusions

5.1 Our ambition is to be the best city in the country. As a vibrant and successful city we will attract new families to Leeds, and making sure that we have enough good school places for the children is one of our top priorities. These proposals have been brought forward to meet that need and our statutory duty regarding sufficiency. They would ensure that children in Leeds would have the best possible start to their learning, and so deliver our vision of a child friendly

5.2 The proposal to expand Gledhow Primary School is a strong one. It would provide additional school places for local children. The governing body support expansion of this outstanding school. Whilst an objection was received at statutory notice phase, there is confidence that the issues raised can be overcome.

5.3 School Organisation Advisory Board (SOAB) met on 13<sup>th</sup> November to consider the Gledhow proposal, the notes of its meeting are attached as Appendix 1.

5.4 It is therefore recommended that the proposal be approved.

## 6 Recommendations

6.1 Executive Board is asked to:

- Approve expansion of Gledhow Primary School by increasing its capacity from 420 pupils to 630 pupils, increasing the admission limit in reception from 60 to 90 from September 2016
- Note the responsible officer for implementation is the Capacity Planning and Sufficiency Lead

## 7 Background documents<sup>1</sup>

7.1 None

---

<sup>1</sup> The background documents listed in this section are available to download from the Council's website, unless they contain confidential or exempt information. The list of background documents does not include published works.